

ITEM NO.	QTY.	PART NO.	DESCRIPTION
1	1	50185	CONVEYOR WMT
2	1	50186	MOTOR SLIDE WMT
3	1	50187	BEARING SLIDE WMT
4	1	11069	DIRT BAFFLE, RIGHT
5	1	11070	DIRT BAFFLE, LEFT
6	2	11113	BEARING MOUNTING PLATE
7	3	60032	FLANGE BEARING, 4 BOLT, 1.25
8	2	60029	FLANGE BEARING, 4 BOLT, 1.00
9	1	60026	WHEEL HUB
10	8	10632	CENTERING GUIDE
11	29	70297	.38UNC X 1.50 ALLEN HEAD TAPER BOLT
12	112	70296	.38UNC X 1.25 ALLEN HEAD TAPER BOLT
13	213	70189	.38 FLAT WASHER
14	186	70130	.38UNC NYLOCK NUT
15	6	10568	WEAR STRIP
16	6	10569	STRAP, MOUNTING
17	1	50168	BELT VIBRATOR
18	1	60149	CROWN PULLY
19	1	60150	CROWN PULLY, 6" X 32"
20	8	70265	.44UNC X 2.00 CARRIAGE BOLT
21	12	70117	.44 SAE FLAT WASHER
22	12	70131	.44UNC NYLOCK NUT
23	5	70164	.50 LOCK WASHER
24	5	70252	.50UNF X 1.25 CAPSCREW
25	16	70016	.62UNC NUT
26	16	70192	.62 FLAT WASHER
27	1	60347	HYDRAULIC MOTOR
28	2	11947	TENSION BOLT
29	2	11948	TENSION BOLT
30	4	70064	.50UNC X 2.75 CAPSCREW
31	4	70191	.50 FLAT WASHER
32	4	70151	.50UNC WHIZ NUT
33	2	66039	ELBOW, 45° 8MJ-10MBO
34	4	70041	.38UNC X 1.75 CAPSCREW
35	4	70116	.38 SAE FLAT WASHER
36	6	70039	.38UNC X 1.25 CAPSCREW
37	2	10610	WEAR STRIP
38	2	10611	WEAR STRIP
39	1	50199	BOOT WMT
40	2	11949	CLAMP STRAP
41	1	11950	CLAMP STRAP
42	2	11951	RUBBER FLAP
43	1	11952	RUBBER FLAP
44	15	70040	.38UNC X 1.50 CAPSCREW
45	4	70264	.44UNC X 1.50 CARRIAGE BOLT
46	4	70118	.50 SAE FLAT WASHER
47	4	70132	.50UNC NYLOCK NUT
48	4	70059	.50UNC X 1.50 CAPSCREW
49	8	70038	.38UNC X 1.00 CAPSCREW
50	1	11953	TIE BAR
51	2	70149	.25UNC WHIZ NUT
52	2	70021	.25UNC X .75 CAPSCREW
53	1	13167	DIRT BAFFLE, RIGHT
54	1	13168	DIRT BAFFLE, LEFT
55	14	13183	WEAR STRIP
56	2	13182	SLIDE
57	2	13169	BELT GUARD
58	1	13185	RUBBER FLAP
59	1	13192	CLAMP STRAP
60	7	70251	.38UNC X 1.75 CARRIAGE BOLT
61	2	13281	HOSE COVER
62	1	60378	BELT, 30" X 42'
63	1	60452	CABLE PIN, PARTS ORDERS ONLY

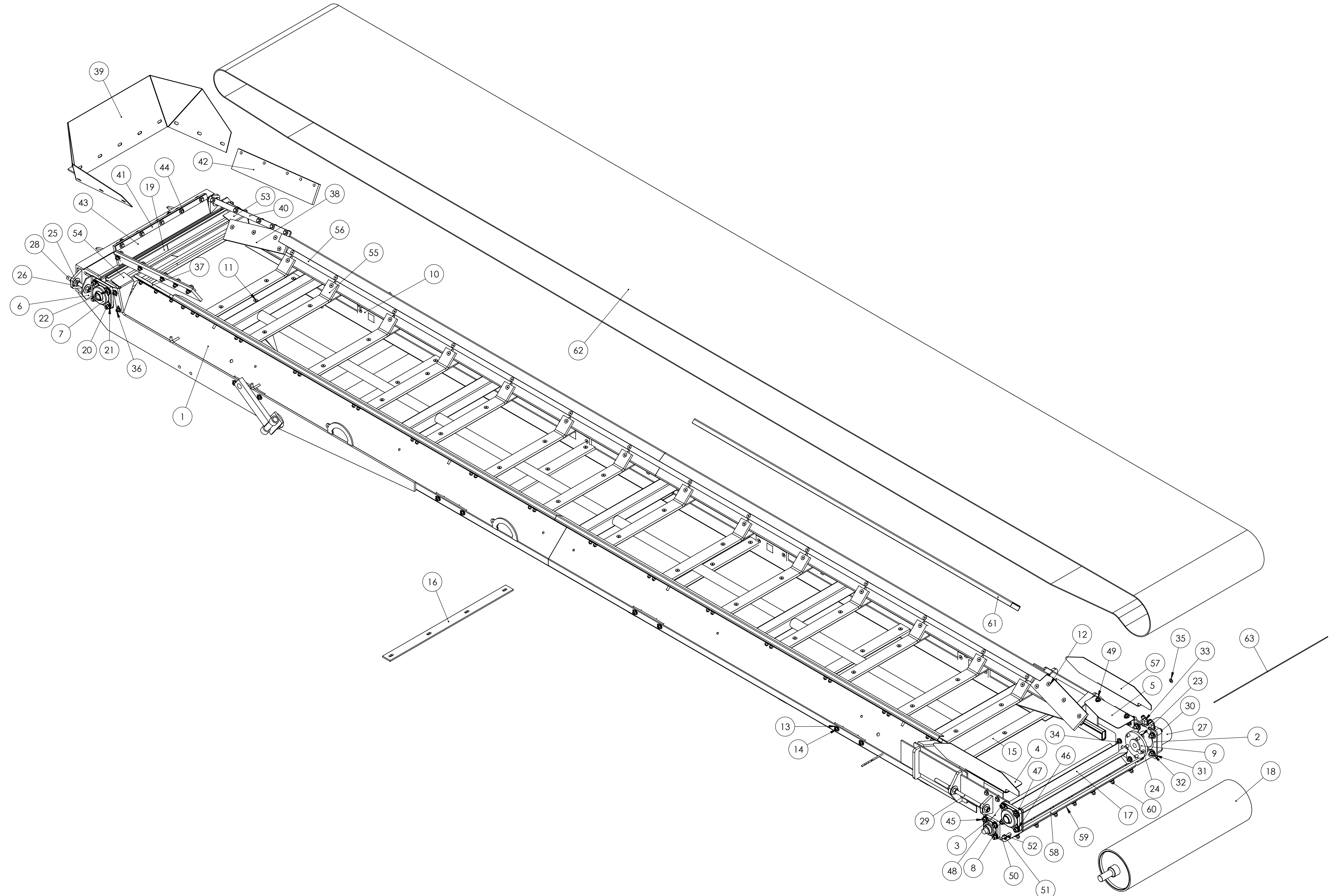

BINDERS: 6, 39

TOLERANCE DECIMAL .XX +/- .03 .XXX +/- .06 .XXXX +/- .010 ANGULAR +/- 1 DEGREE UNLESS OTHERWISE SPECIFIED	THIS DRAWING AND ALL INFORMATION THEREON IS PROPERTY OF ORBIT SCREENS, INC. AND MUST NOT BE USED IN ANY WAY WITHOUT PRIOR CONSENT OR IN ANY WAY DETRIMENTAL TO THE INTEREST OF ORBIT SCREENS.				1051#	XX	XX
	E				WEIGHT	MATL QTY	FIRST USED
	D				TITLE		
	C				FINES CONVEYOR ASSY		
B	ADDED (2) 13281 AND (1) 60452	04/22/10	SI	CHECKED	DATE	TITLE	
A	RELEASED FOR PRODUCTION	09/18/09	SI			MATERIAL	
REV	DESCRIPTION	DATE	BY			SCALE	
						1:2 DO NOT SCALE DWG DEBURR PART	
						PART NO. 50177	

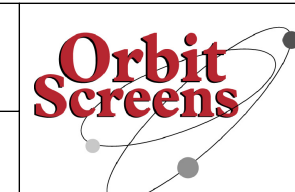

505 3RD STREET
P.O. BOX 345
DELHI, IOWA 52223
PHONE: 563-922-9230
FAX: 563-922-9060

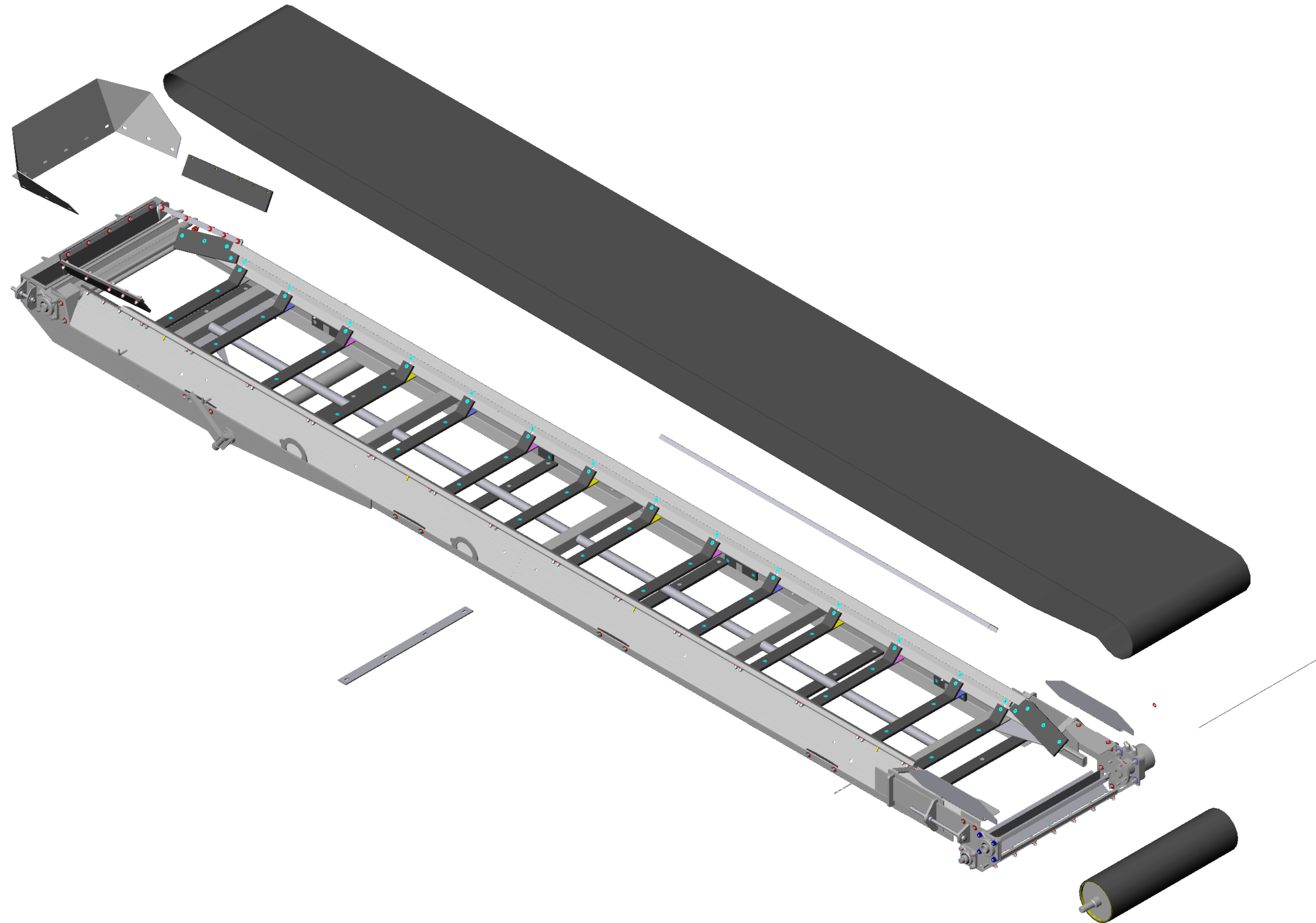

TOLERANCE DECIMAL .XX +/- .03 .XXX +/- .06 .XXXX +/- .010 ANGULAR +/- 1 DEGREE UNLESS OTHERWISE SPECIFIED		THIS DRAWING AND ALL INFORMATION THEREON IS PROPERTY OF ORBIT SCREENS, INC. AND MUST NOT BE USED IN ANY WAY WITHOUT PRIOR CONSENT OR IN ANY WAY DETRIMENTAL TO THE INTEREST OF ORBIT SCREENS.				XX	XX	XX
3RD ANGLE PROJECTION		DRAWN		DATE	TITLE			
		SI		09/18/09	FINES CONVEYOR ASSEMBLY			
		CHECKED		DATE	MATERIAL			
					XX			
		REV		DATE	SCALE		PART NO.	
		DESCRIPTION			DO NOT SCALE DWG DEBURR PART		50177	

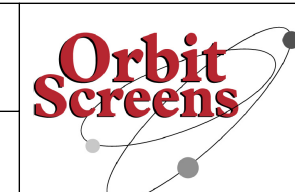

505 3RD STREET
 P.O. BOX 345
 DELHI, IOWA 52223
 PHONE: 563-922-9230
 FAX: 563-922-9060